

➤ BUTTERFLY VALVE TYPE MV-PKM

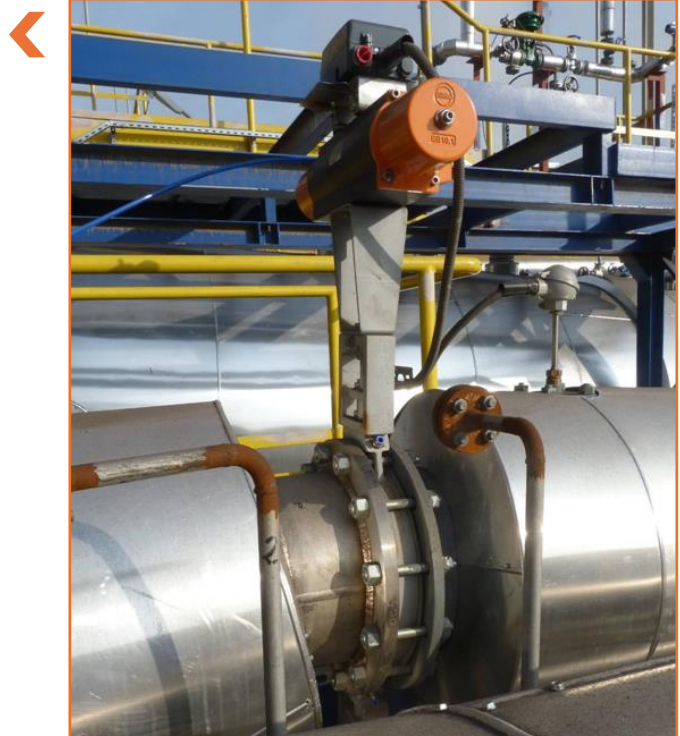



- butterfly valve type MV-PKM, mounted between pipe flanges, is used as a control or shut-off valve intended for operation with air or process gases,
- lamellar sealing suitable for dusty gases,
- possibility of customising face to face length,
- standard shaft working position: horizontal (available versions with a shaft positioned vertically),
- leakage rate up to 0.1% Kvs (available with sealing ensuring 100% tightness),
- lightweight shaft version for operation in ventilation systems,
- butterfly valve MV-PKM is used in power generation, chemical, petrochemical, metallurgical, mining, cement, paper and sugar industries.

TECHNICAL DATA

Nominal diameter:	DN 50 do DN 1200, intermediate and larger diameters made to special orders
Temperature range:	-40°C to 1100°C (depending on material)
Actuator:	electric, pneumatic, hand actuator,
Actuator adaption:	ISO 5211 or customised
Nominal diameter:	DN 50 do DN 1200, intermediate and larger diameters made to special orders
Working pressure:	Up to 0,5 bar relative. Versions above 0,5 bar made to special orders

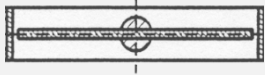

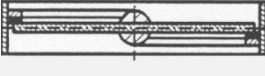
Butterfly valve type MV-PKM

Inside leakage rate			
1		Without landing bar	$\leq 5\%$ Kvs
2		With landing bar	$\leq 0,5\%$ Kvs
3		With landing bar and soft sealing	$\leq 0,1\%$ Kvs
4		With lamellar sealing	$\leq 0,5\%$ Kvs
5		With lamellar sealing and slanted seat wewnętrzna	$\leq 0,1\%$ Kvs

Materials:

carbon steel
boiler steel
stainless steel
creep resistant and heat resistant steel
other materials available on special order

Corrosion resistance:

primer paint
zinc plating or hot-dip galvanization
high temperature resistance coating
abrasion resistance coating
etching and passivation (stainless steels)
etc.

Shaft sealing:

graphite
ceramic
Teflon
air sealing system
other sealing types available depending on medium and temperature

We can provide customised solutions meeting special requirements.

Butterfly valve type MV-PKM

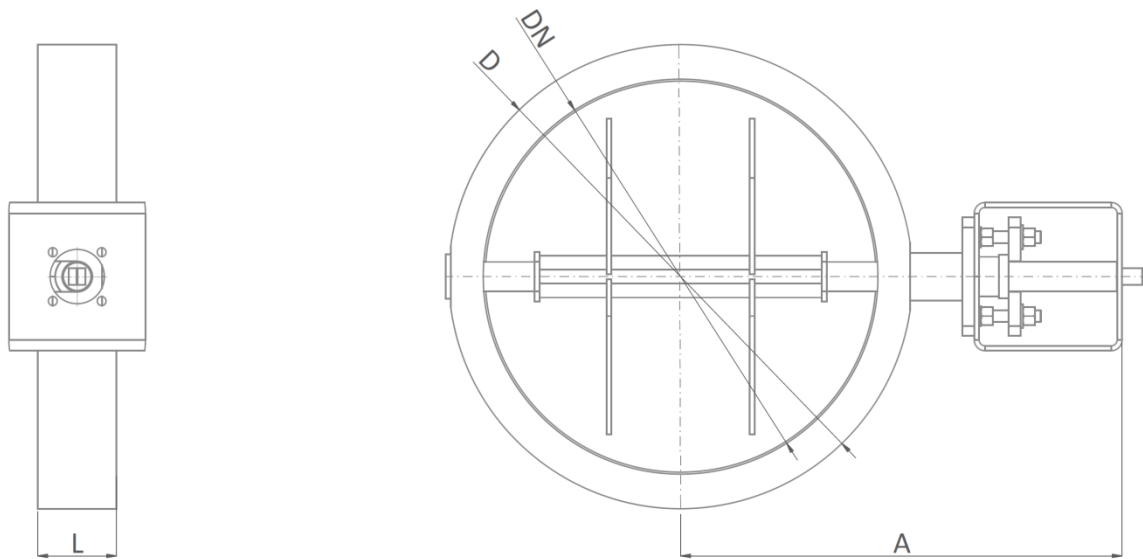

Design dimensions

DN [mm]	Face to Face L [mm]	Outside diameter D [mm]	Length* A [mm]
50	35	85	320
65	35	105	330
80	40	120	340
100	40	140	350
125	45	170	365
150	50	195	380
200	50	255	400
250	50	310	430
300	55	360	460
350	55	415	490
400	60	465	520
450	60	465	540
500	65	570	570
600	75	675	630
700	80	780	680
800	85	880	730
900	90	980	800
1000	100	1080	850
1200	100	1295	950

* The length can vary depending on medium parameters and process conditions.

The valve design can be suited to individual customer requirements taking into account valve dimensions (diameter, flange drilling, thickness flange and length) mounting arrangements and process requirements.

Butterfly valve type MV-PKM

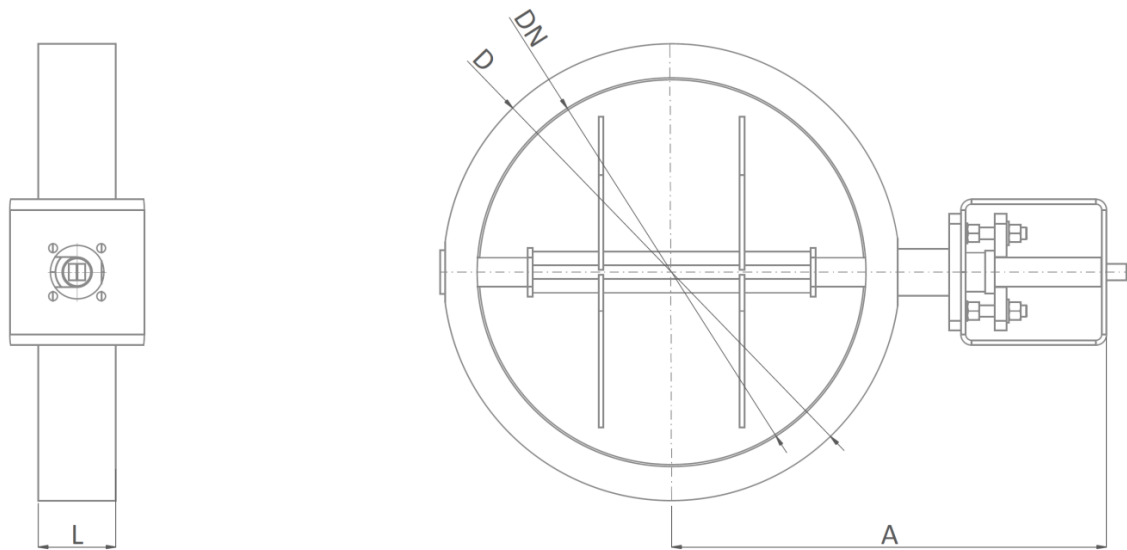

Design dimensions – lightweight version

DN [mm]	Face to face L [mm]	Outside diameter D [mm]	Length* A [mm]
150	40	179	380
160	40	185	385
180	40	206	395
200	40	225	400
224	40	275	420
250	40	280	430
280	40	320	450
300	45	338	460
315	45	350	470
355	45	392	490
400	50	425	520
450	50	485	540
500	50	530	570
560	60	610	610
600	60	650	630
630	60	680	660
710	70	760	690
800	80	845	730
900	100	942	800
1000	100	1050	850

* The length can vary depending on medium parameters and process conditions.
The valve design can be suited to individual customer requirements taking into account valve dimensions (diameter, flange drilling, thickness flange and length) mounting arrangements and process requirements.



Butterfly valve type MV-PKM Order form

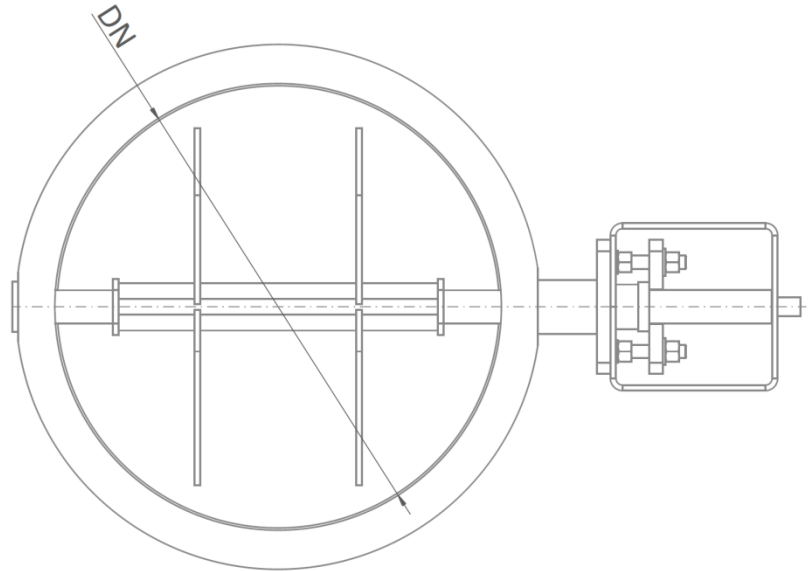
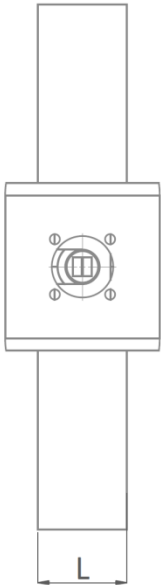

Version*:
Standard / Lightweight

Dimensions:
Diameter DN =
Face to face** L =

Type of actuator*:
Manual / Pneumatic / Electric/ Hydraulic

Position of the shaft*:
Horizontal / Vertical

Tightness:
Leakage rate % Kvs

Medium:
.....
.....
Max. working temperature°C
Working pressurebar/kPa*

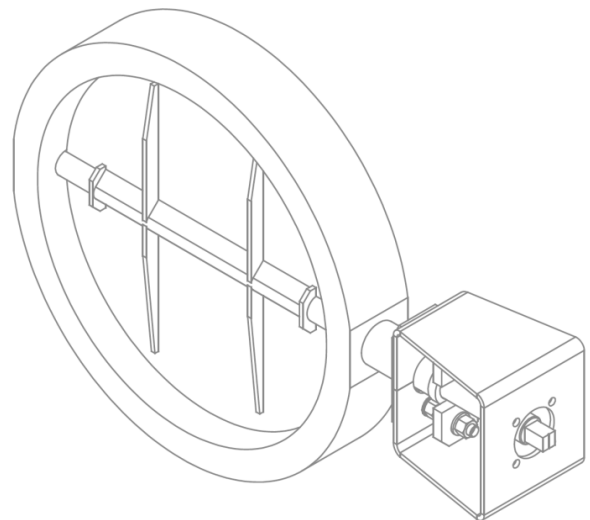

* delete as appropriate
** only in the case of non-standard implementations



multivalve

Multivalve Sp. z o.o.
44-109 Gliwice, ul. Eiffel'a 6
tel. + 48 32 661 00 00
fax: + 48 32 661 00 01
multivalve@multivalve.pl
www.multivalve.pl

TÜV Rheinland certified
ISO 9001 - 2008