

## DISMANTLING JOINT TYP MV-KA/F2

- dismantling joint with axial mounting clearance, applied for installing and removing various types of shut-off and regulating valves,
- possibility of customising face to face length and flange connections,
- dismantling joint is intended for operation with air, gas, drinking water, process water, sewage and other media,
- all stainless steel elements undergo etching and passivation by dipping or spraying,
- dismantling joint MV-KA/F2 is used in water supply management and waste-water treatment, power generation, mining, chemical, petrochemical, metallurgical, cement and paper industries.

## TECHNICAL DATA

<b>Flange drilling:</b>	PN 2,5, PN 6, PN 10, PN 16, PN 25 or others
<b>Nominal diameter:</b>	DN 50 to DN 2000. customised diameters and diameters above DN 2000 made to special orders
<b>Material:</b>	carbon steels, stainless steels, acid resistant steels etc.
<b>Corrosion protection:</b>	primer painting, epoxy/bitumen, coating, zinc plating or hot dip galvanization, etching and passivation (stainless and acid resistant steels)
<b>Seal:</b>	EPDM, NBR, Silicone, Viton or others
<b>Standardized elements:</b>	galvanized, A2, A4

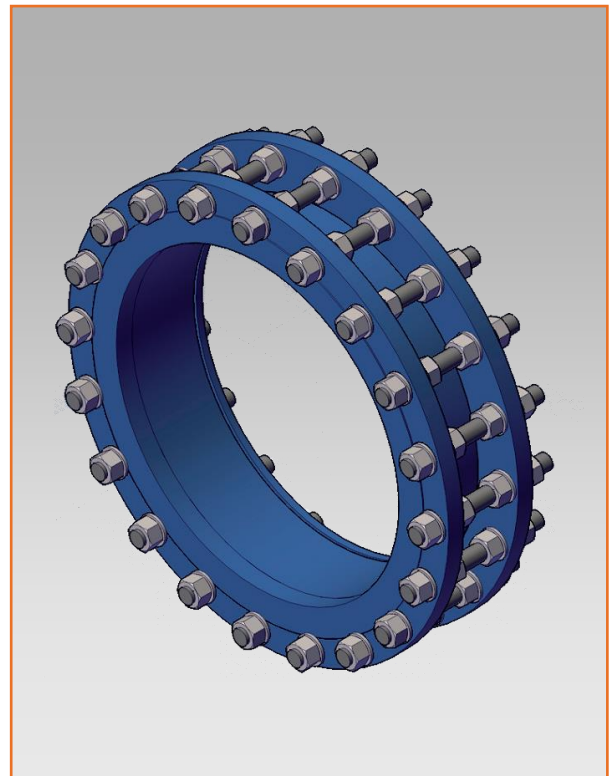



## Dismantling joint typ MV-KA/F2

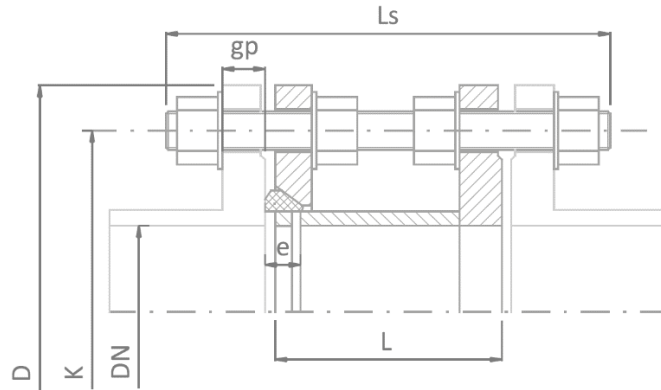

PN-EN 1092-1

Design dimensions based on PN 10

DN [mm]	Face to face L [mm]	Mounting clearance e [mm]	Outside diameter D [mm]	Pitch circle diameter K [mm]	Number of threaded rods [pcs.]	Size of threaded rods [mm]	Length of threaded rods Ls [mm]	Counter flange thickness gp [mm]*	Weight [kg]
50	120	8	165	125	4	M16	200	18	7
65	120	8	185	145	8	M16	200	18	8,5
80	120	8	200	160	8	M16	210	20	10
100	120	8	220	180	8	M16	210	20	14,5
125	120	10	250	210	8	M16	210	22	18
150	120	10	285	240	8	M20	210	22	22
200	130	10	340	295	8	M20	230	24	30
250	130	10	395	350	12	M20	230	26	42,5
300	130	10	445	400	12	M20	230	26	45
350	130	10	505	460	16	M20	230	26	59
400	130	10	565	515	16	M24	250	26	74
450	130	10	615	565	20	M24	250	28	81
500	150	10	670	620	20	M24	270	28	92
600	150	10	780	725	20	M27	280	30	121
700	150	12	895	840	24	M27	290	35	156
800	150	12	1015	950	24	M30	300	38	202
900	150	12	1115	1050	28	M30	300	38	248
1000	150	12	1230	1160	28	M33	320	44	294
1200	175	14	1455	1380	32	M36	370	55	357
1400	175	16	1675	1590	36	M39	400	65	401
1600	175	16	1915	1820	40	M45	420	75	467

\*CAUTION! Counter flange thickness verification required!

Other versions available on special order



## Dismantling joint typ MV-KA/F2

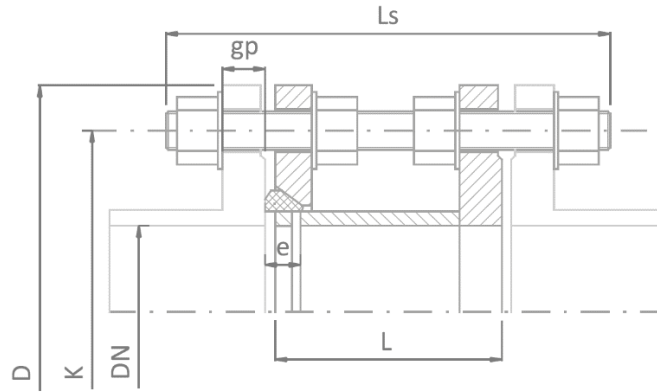

PN-EN 1092-1

Design dimensions based on PN 16

DN [mm]	Face to face L [mm]	Mounting clearance e [mm]	Outside diameter D [mm]	Pitch circle diameter K [mm]	Number of threaded rods [pcs.]	Size of threaded rods [mm]	Length of threaded rods Ls [mm]	Counter flange thickness gp [mm]*	Weight [kg]
50	120	8	165	125	4	M16	200	18	7
65	120	8	185	145	4	M16	200	18	8,5
80	120	8	200	160	8	M16	210	20	11
100	120	8	220	180	8	M20	210	20	14
125	120	10	250	210	8	M20	210	22	18
150	120	10	285	240	8	M20	220	22	22
200	130	10	340	295	12	M20	230	24	30
250	130	10	405	355	12	M20	250	26	47
300	130	10	460	410	12	M20	250	28	56
350	130	10	520	470	16	M24	260	30	77
400	130	10	580	525	16	M24	260	32	100
450	130	10	640	585	20	M27	270	34	125
500	150	10	715	650	20	M27	300	36	158
600	150	10	840	770	20	M30	310	40	225
700	150	12	910	840	24	M30	320	40	240
800	150	12	1025	950	24	M33	320	41	310
900	150	12	1125	1050	28	M36	330	48	355
1000	150	12	1255	1170	28	M39	360	59	465
1200	175	14	1485	1390	32	M45	430	78	571
1400	175	16	1685	1590	36	M45	460	84	690
1600	175	16	1930	1820	40	M45	500	102	805

\*CAUTION! Counter flange thickness verification required!

Other versions available on special order

## Dismantling joint typ MV-KA/F2

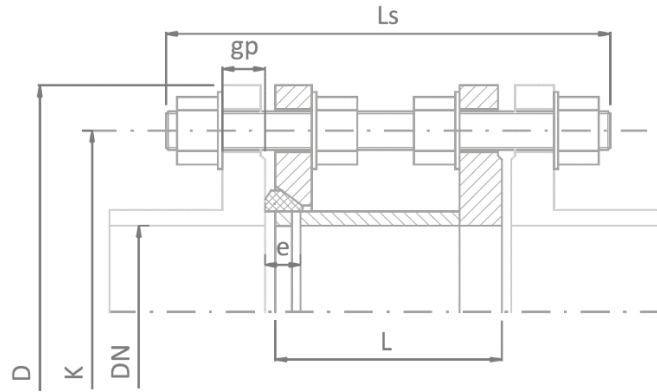

PN-EN 1092-1

Design dimensions based on PN 25

DN [mm]	Face to face L [mm]	Mounting clearance e [mm]	Outside diameter D [mm]	Pitch circle diameter K [mm]	Number of threaded rods [pcs.]	Size of threaded rods [mm]	Length of threaded rods Ls [mm]	Counter flange thickness gp [mm]*	Weight [kg]
50	110	8	165	125	4	M16	200	20	7
65	110	8	185	145	8	M16	200	22	10
80	110	8	200	160	8	M16	200	24	12
100	130	8	235	190	8	M20	250	24	18,5
125	130	10	270	220	8	M24	250	26	24,5
150	130	10	300	250	8	M24	250	28	29,5
200	130	10	360	310	12	M24	250	30	43
250	150	10	425	370	12	M27	290	32	60
300	150	10	485	430	16	M27	290	34	80
350	170	10	555	490	16	M30	330	38	116
400	170	10	620	550	16	M33	330	40	147
450	200	10	670	600	20	M33	380	46	191
500	200	10	730	660	20	M33	380	48	220
600	200	10	845	770	20	M36	380	48	263
700	250	12	960	875	24	M39	450	50	380
800	250	12	1085	990	24	M45	500	53	490
900	250	12	1185	1090	28	M45	500	57	573
1000	250	12	1320	1210	28	M52	500	63	782

\*CAUTION! Counter flange thickness verification required!

Other versions available on special order



## Dismantling joint typ MV-KA/F2 Order form

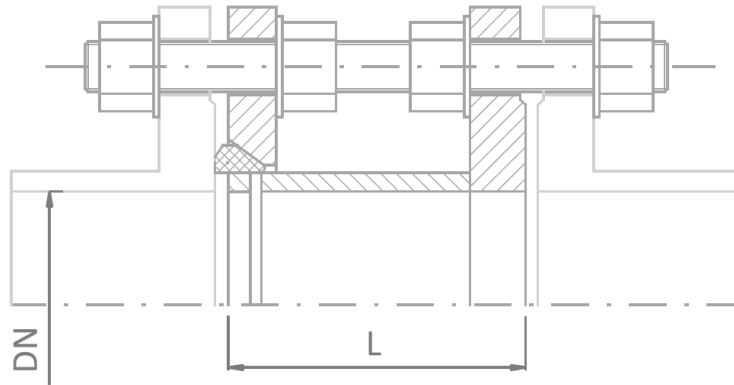

Material\*:

1. Carbon steel (S235JR/S355JR or others), with one of available coatings: epoxy/bitumen/galvanized
2. Stainless steel and acid resistant steel (1.4301/1.4541/1.4571 or others)

Standardized elements\*:

Galvanized/A2/A4

Seal\*:

EPDM/NBR/Silikon/Viton

Dimensions:

Nominal diameter                      DN = .....

Face to face length\*\*                L = .....

\* delete as appropriate, other versions available on special order

\*\* only in the case of non-standard variants

REMARKS:

.....

.....

.....

.....

.....

.....



**multivalve**

Multivalve Sp. z o.o.  
44-109 Gliwice, ul. Eiffel'a 6  
tel. + 48 32 661 00 00  
fax: + 48 32 661 00 01  
multivalve@multivalve.pl  
www.multivalve.pl

TÜV Rheinland certified  
**ISO 9001 - 2008**